

FAM TRIP VALENCIA REGION



FAM TRIP TO SPAIN MADRID AND VALENCIA REGION

FAM TRIP VALENCIA REGION | Schedule

DAY 4 – Saturday 28

8.30 - 10.20 Madrid – Valencia **high-speed train**
10.20 Arrival to Valencia
10.45-12.45 Walk and bike tour around the **historic center** (tasting horchata) **and Turia Gardens**
12.45 **City of Arts and Science**
13.30 **Lunch at Alcatí Club (Albufera)**
17.00 **Meliá Valencia welcome**
19.00 Dinner at **Villa Indiano**
22.00 END OF DAY

DAY 5 – Sunday 29

9.30 Pick up at hotel
10.30 Visit **San Jeronimo de Cotalba Monastery**
12.15 Visit **Ducal Palace in Gandia - House of Borgia**
13.15 Fideua contest and Lunch
15.30 Stroll on **beach in Gandia**
16:15 Visit **Port of Gandia**
17.30 End of Film Valencia's part of the trip. Continue on to **Benidorm**
18:30 check in Hotel & visit Old City

DAY 6 – Monday 30

8.30 Pick up at hotel, Transfer to **Elche and Visit el Palmeral**
10.30 Transfer and visit **City of Light Studios**
14:00 Lunch at **City of Light Studios Peñíscola** Film Office Presentation and B2B with **Regional Film Office**
16.30 Check-in **Melia hotel**
18.00 Sunset at **Santa Bárbara Castle**
19.00 Dinner in **Salon Felipe II at Santa Bárbara Castle**

DAY 6 – Tuesday 31

Check Out and transfer to the Alicante-Elche Airport Miguel Hernández

SERRANOS TOWERS



PLAZA DE LA VIRGEN



PLAZA REDONDA



CENTRAL MARKET



OLD RIVER BED



CITY OF ARTS AND SCIENCE

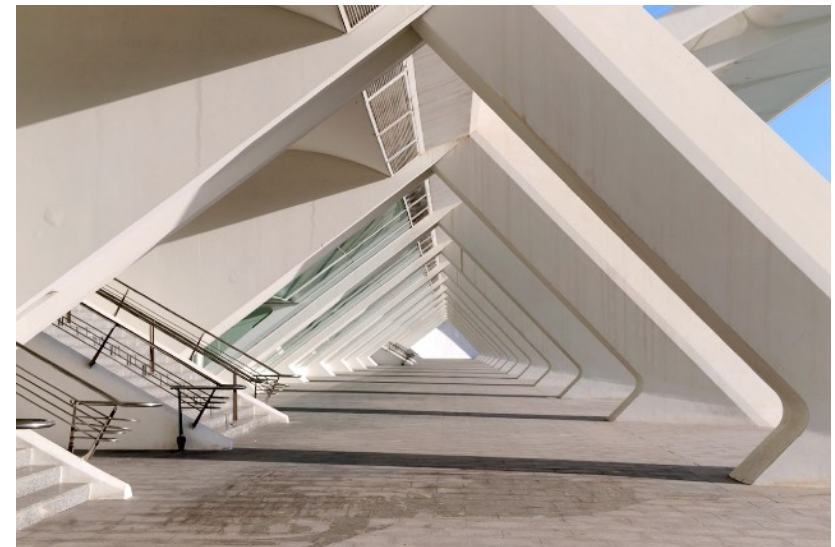
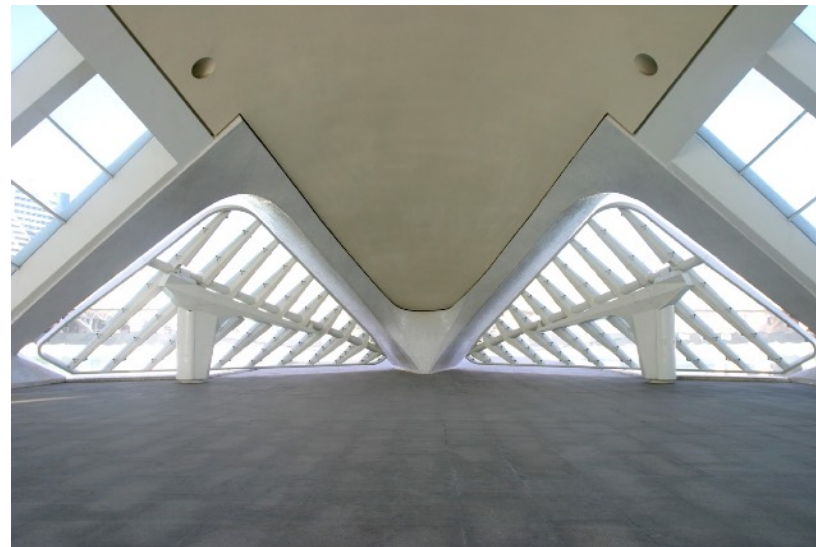
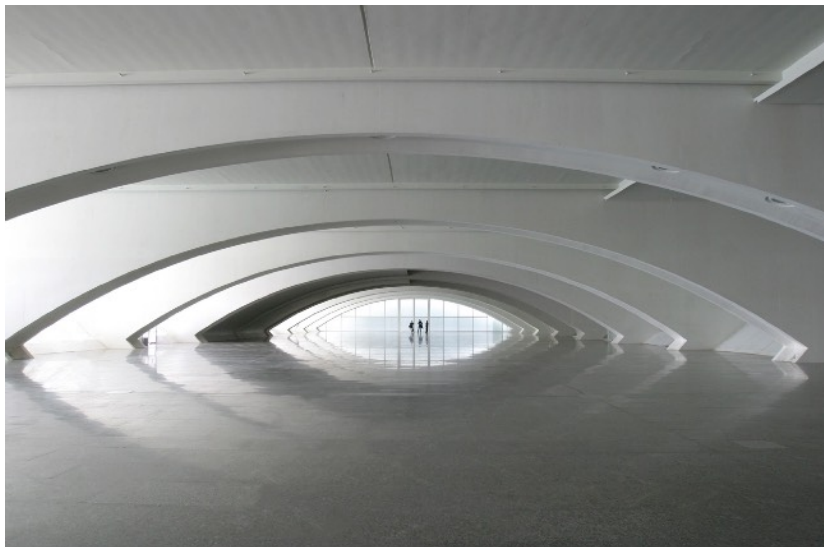

ALCATÍ



VILLA INDIANO



MELIÀ VALENCIA



CITY OF VALENCIA

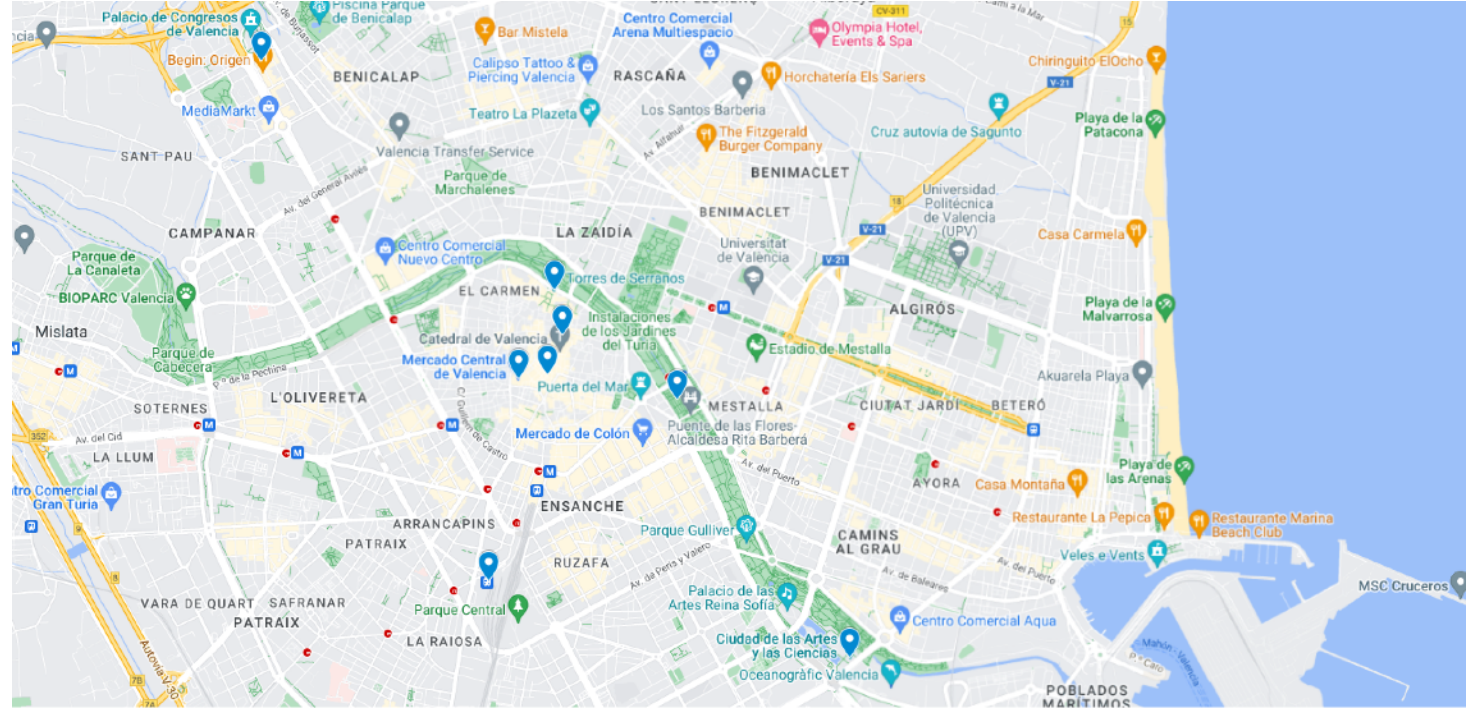
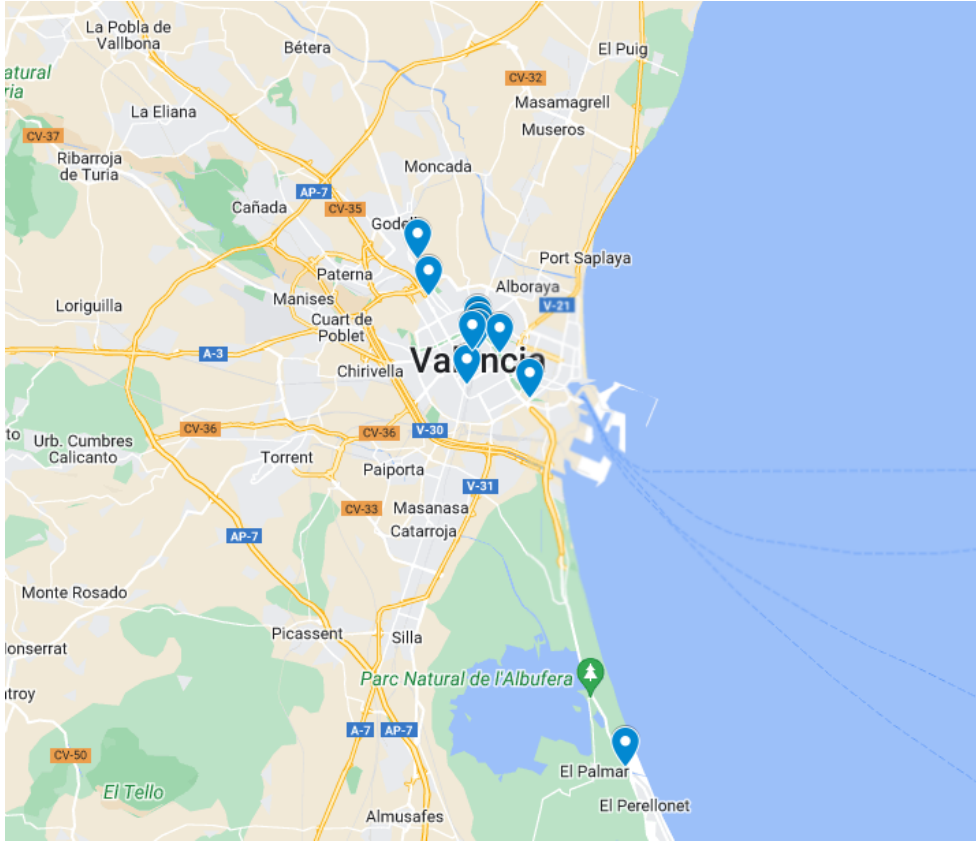

Palacio Ducal de los Borgia



15th century Valencian Gothic and Baroque style Palace housing remarkable spaces like the Golden Gallery and the Crown Hall



[GEOLOCATION](#)



Monasterio San Jerónimo de Cotalba



A monastic building of Gothic, Mudéjar, Renaissance, Baroque and Neoclassical styles constructed between the 14th and 18th centuries



[GEOLOCATION](#)



Gandia beach, port and boardwalk



Gandia's 4 different beaches make up over 7km of coastline where you can find from an urban boardwalk setting to a wild beach



[GEOLOCATION](#)



MELIA VILLAITANA BENIDORM



GEOLOCATION



FUN WEST EL CAMPELLO



GEOLOCATION



ELCHE CITY "EL PALMERAL"



GEOLOCATION



WILD PALM GREEN



GEOLOCATION



CITY OF LIGHT STUDIOS



GEOLOCATION



HOTEL MELIA ALICANTE CITY



GEOLOCATION



SANTA BARBARA CASTLE ALICANTE



GEOLOCATION



FILM OFFICE IN COSTA BLANCA REGION





CONTACT PERSONS:

Valencia Film Office

Pepa Jordá – pepa.jorda@visitvalencia.com

www.valenciafilmoffice.org

Film Valencia

Ann Hernández – filmvalencia.ann@gmail.com

www.filmvalencia.com

Costa Blanca Film Commission

Víctor Mirete – vmirete@costablanca.org

www.costablanca.org/Esp/costablanca-ahora/cb-film-commission

Alicante Film Office

Santiago Alcázar – santiago.alcazar@alicante.es

www.alicantefilmoffice.com/

Ciudad de la Luz

Marta Bellod – mbellod@sptcv.net

Marisol Blázquez – msblazquez@sptcv.net

<https://sptcv.net/ciudad-de-la-luz/>

Peñíscola Film Office

Laura Hidalgo – lhidalgojorda@gmail.com

<https://www.peñiscola.es/film-office>